

# ***INSTRUCTION MANUAL***

## **FALSE CEILING TRIM KIT (FCK)**

### ***COMPACT***

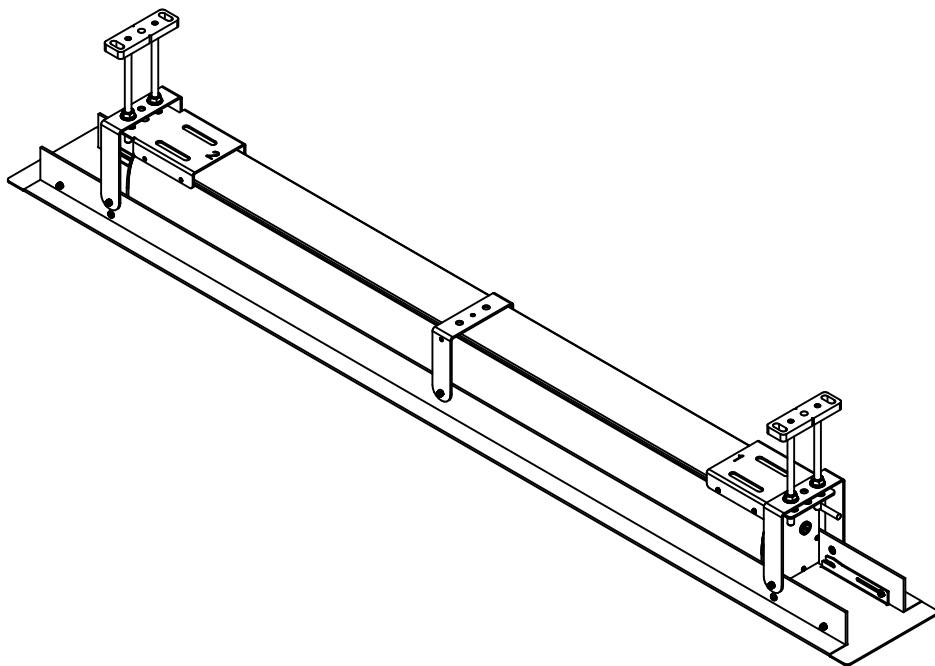

**ORIGINAL INSTRUCTIONS IN ITALIAN LANGUAGE**  
**Translation into English language**



# INDEX

COMPONENTS INSIDE THE PACKAGING - FCK COMPACT	page.	4
DIMENSIONS - FCK COMPACT	page.	5
ASSEMBLING - FCK COMPACT	page.	6
MOUNTING TO THE CEILING - FCK COMPACT	page.	7
MOUNTING THE SCREEN ONTO THE FCK	page.	9

# COMPONENTS INSIDE THE PACKAGING

## FCK COMPACT

When you open the packaging, please CHECK that it contains ALL the components below. In case, one or more components are missing, please refer to the dealer you purchased the product from.

**A** Pcs. 02  
White long "L" form profiles  
pre-punched

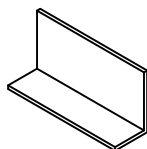

**B** Pcs. 01  
White "C" form support

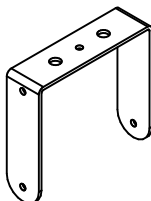

**C** Pcs. 02  
White structural "C" form  
supports

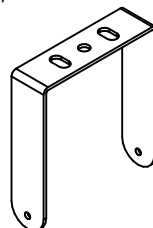

**D** Pcs. 02  
White side doors

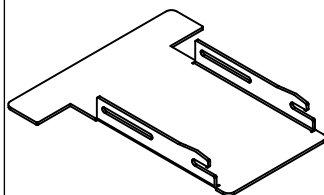

**E** Pcs. 01  
White mounting plate "1"  
screen housing

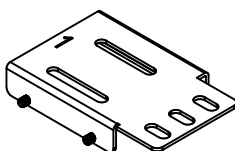

**F** Pcs. 01  
White mounting plate "2"  
screen housing

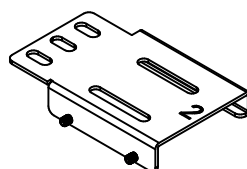

**G** Pcs. 02  
Ceiling mounting plates

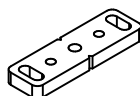

**H** Pcs. 12  
Nuts M8



**I** Pcs. 04  
Threaded rods M8x1000mm.



**J** Pcs. 04  
Flanged nuts M8



**K** Pcs. 08  
Flat washers  $\varnothing 25 \times 2$  M8



**L** Pcs. 04  
Button head screws  
M4x12mm.



**M** Pcs. 06  
Countersunk flat head  
screws M4x10mm



**N** Pcs. 10  
Self-blocking nuts M4



**O** Pcs. 04  
Button head screws  
M4x6mm.



# DIMENSIONS - FCK COMPACT

## FRONT VIEW FCK COMPACT

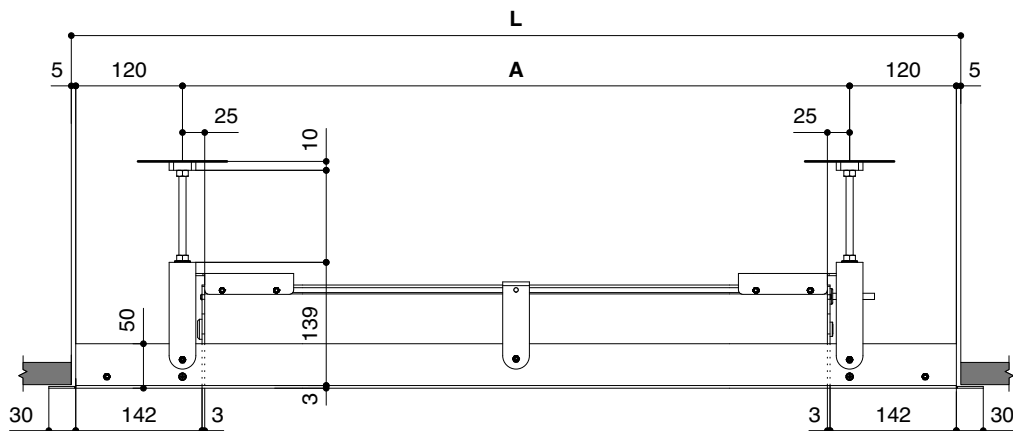

## FIXING POINTS DIMENSIONS OF CEILING MOUNTING PLATE

	A (mm)	B (mm)
<b>COMPACT PROFESSIONAL</b> (Without borders)	Width of Viewing Area + 115	82
<b>COMPACT HOME CINEMA</b> (With side borders of 50 mm)	Width of Viewing Area + 215	82
<b>COMPACT TENSIONED</b>	Width of Viewing Area + 405	82

## DIMENSIONS HOLE IN FALSE CEILING

	L (mm)	P (mm)
<b>COMPACT PROFESSIONAL</b> (Without borders)	Width of Viewing Area + 365	130
<b>COMPACT HOME CINEMA</b> (With side borders of 50 mm)	Width of Viewing Area + 465	130
<b>COMPACT TENSIONED</b>	Width of Viewing Area + 655	130

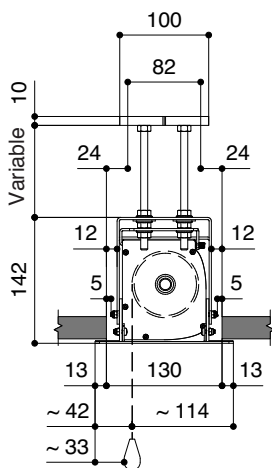

## TOP VIEW CEILING MOUNTING PLATE

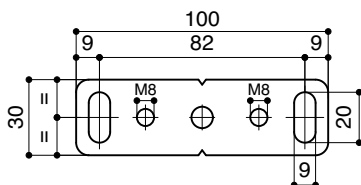

## HOLE IN FALSE CEILING AND FIXING POINTS CEILING

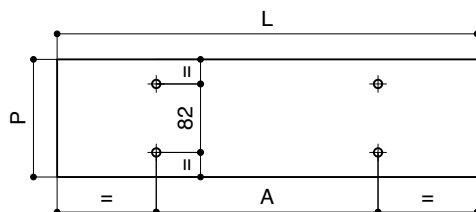

# ASSEMBLING - FCK COMPACT

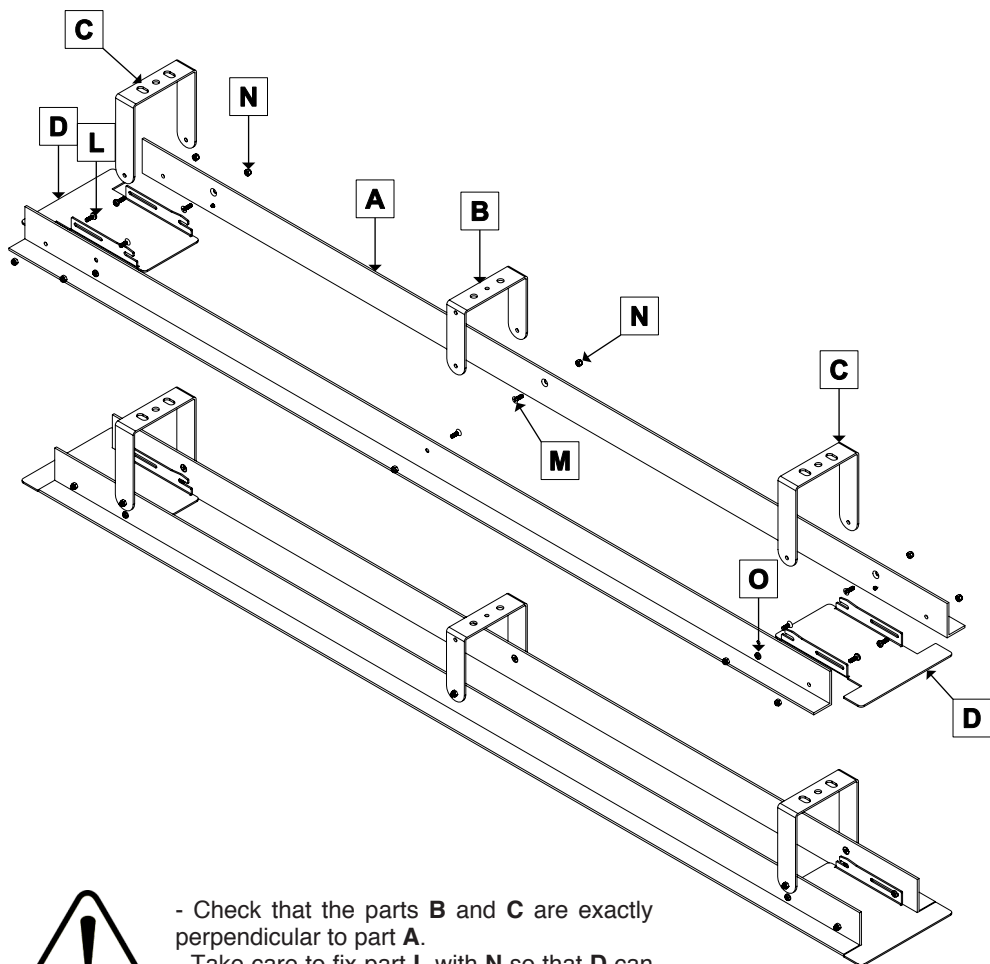

- Check that the parts **B** and **C** are exactly perpendicular to part **A**.
- Take care to fix part **L** with **N** so that **D** can be rotated.

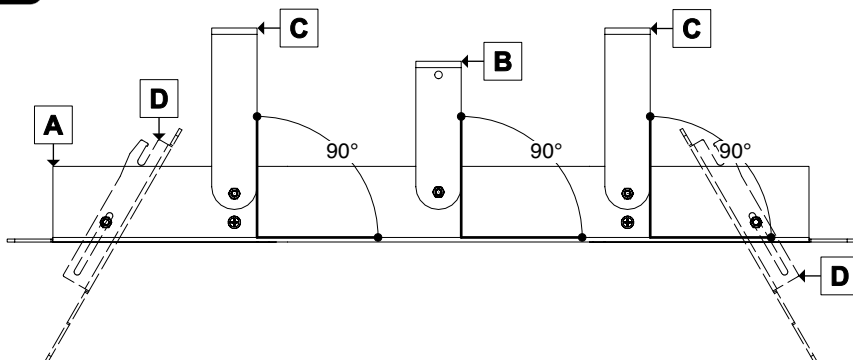

# MOUNTING TO THE CEILING - FCK COMPACT



Hole to be drilled in the upper ceiling

- The installer has to choose suitable plugs (NOT SUPPLIED) for the fixing of the ceiling mounting plates onto the upper ceiling.

- Before mounting the parts onto the ceiling, cut the threaded rods to the desired length.

(see p.8 regarding minimum and maximum length of the rods)

Plug not supplied

Screw not supplied

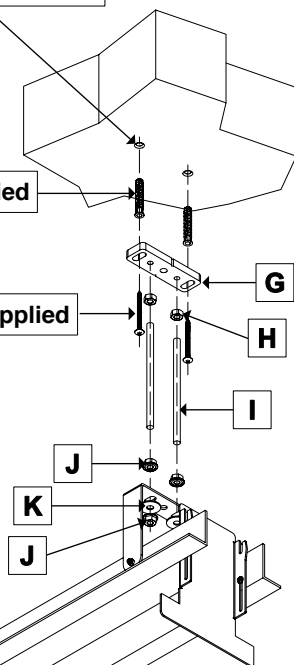
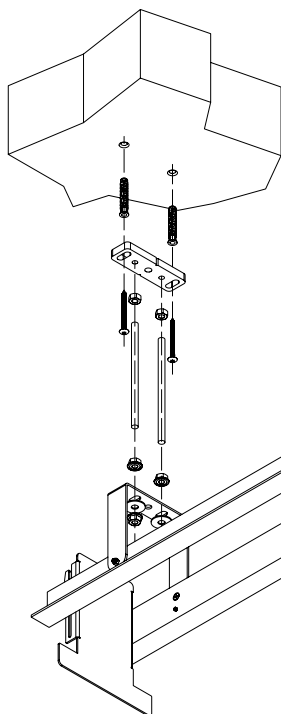

In order to fix the threaded rods (I) to the ceiling mounting plates (G), screw a bolt (H) for at least 20 mm. To the top part of the threaded rod.

Screw the threaded rods in the ceiling mounting plates, making sure that the thread is inserted through all the depth of the plate (10mm). Then, clamp the bolt tightly.

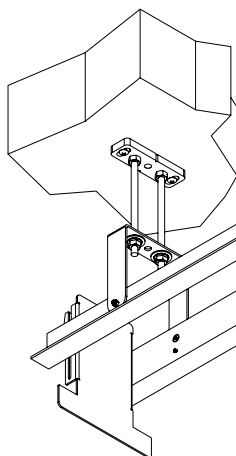
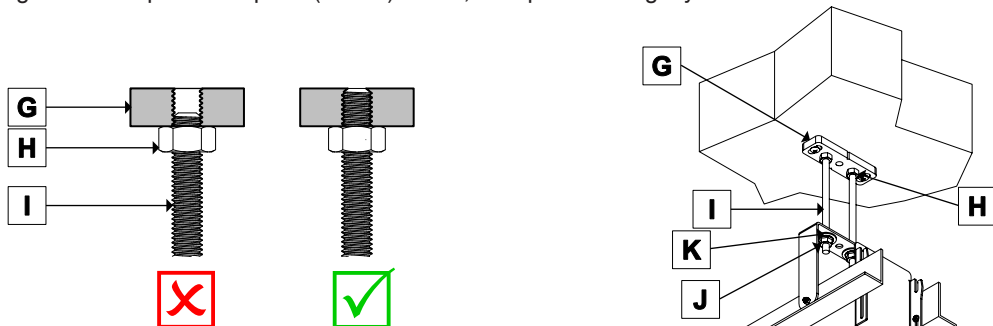

Take the preassembled FCK and lift it up inserting the threaded rods onto the structural "C" form supports (C) and screw the washers (K) and the flanged nuts (J).



Verify that the bottom part of the FCK is perfectly leveled. A non leveled installation of the FCK will cause bad functioning of the projection screen.

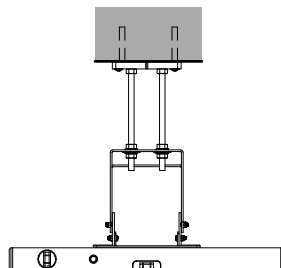
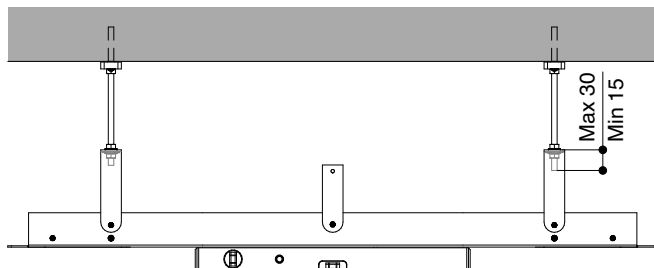



# MOUNTING THE SCREEN ONTO THE FCK



Before you proceed with mounting the screen, fix the mounting plates (E) and (F), as indicated in the drawing below.

**It is IMPORTANT to mount the right plate to the right side.**

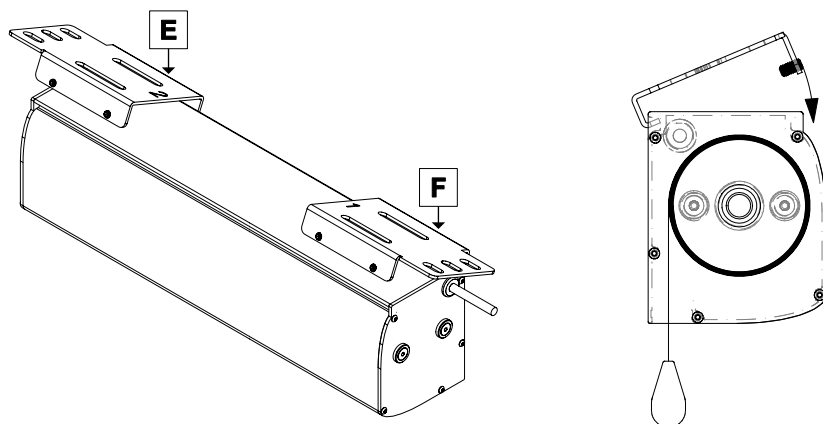

Before fixing the screws, check that the mounting plates (E) and (F) are positioned towards the end of the screen housing.

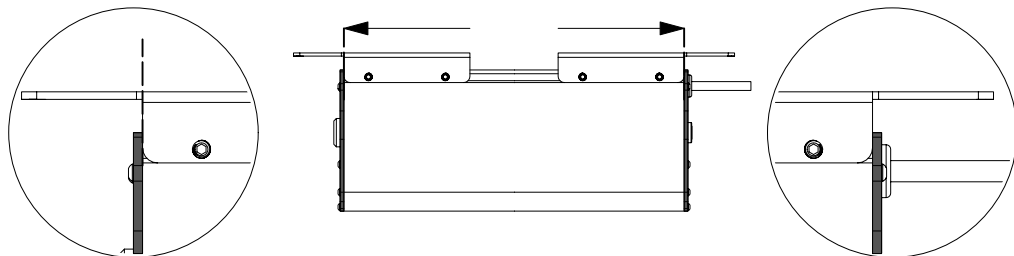

Now fix the all the screws tightly and check that both mounting plates are firmly fixed to the screen housing.

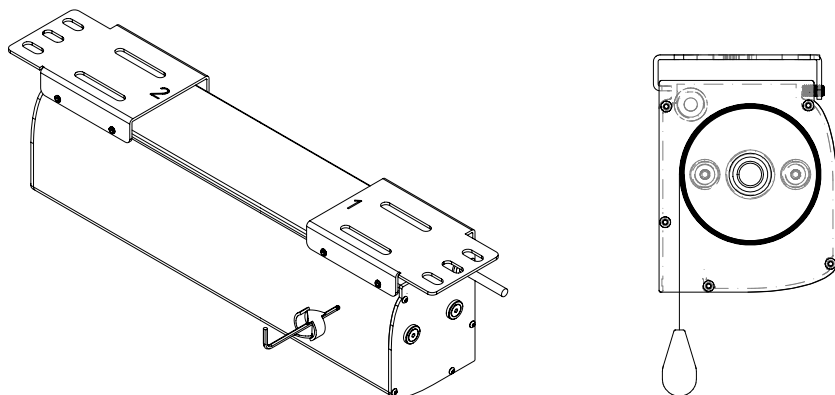

Now open the left and right side doors (D) of the FCK and keep them in vertical position.

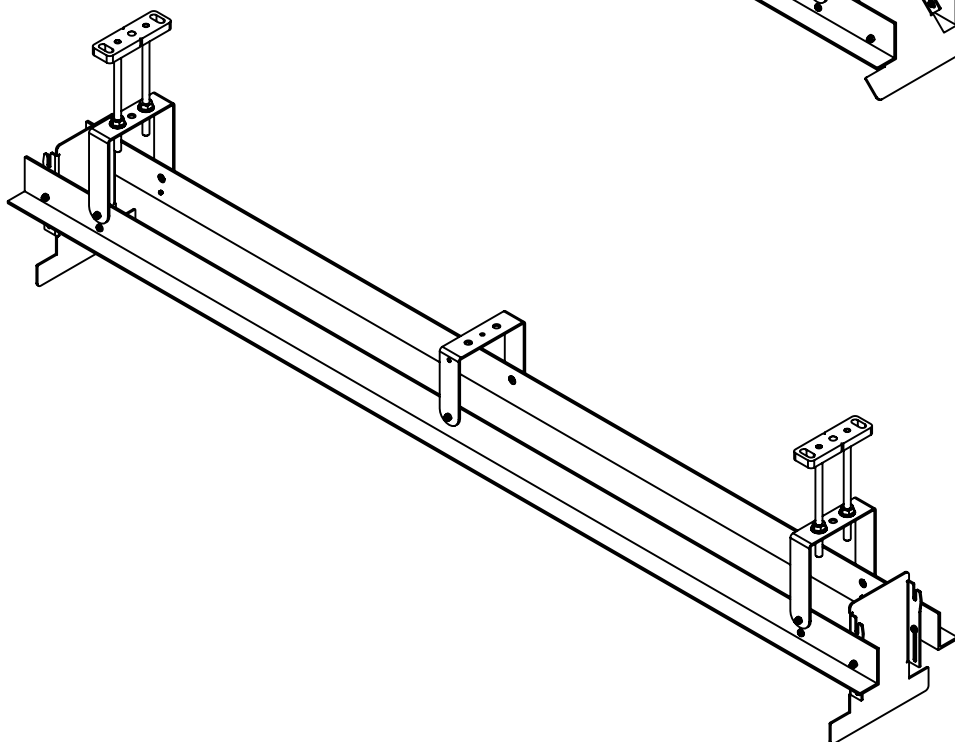
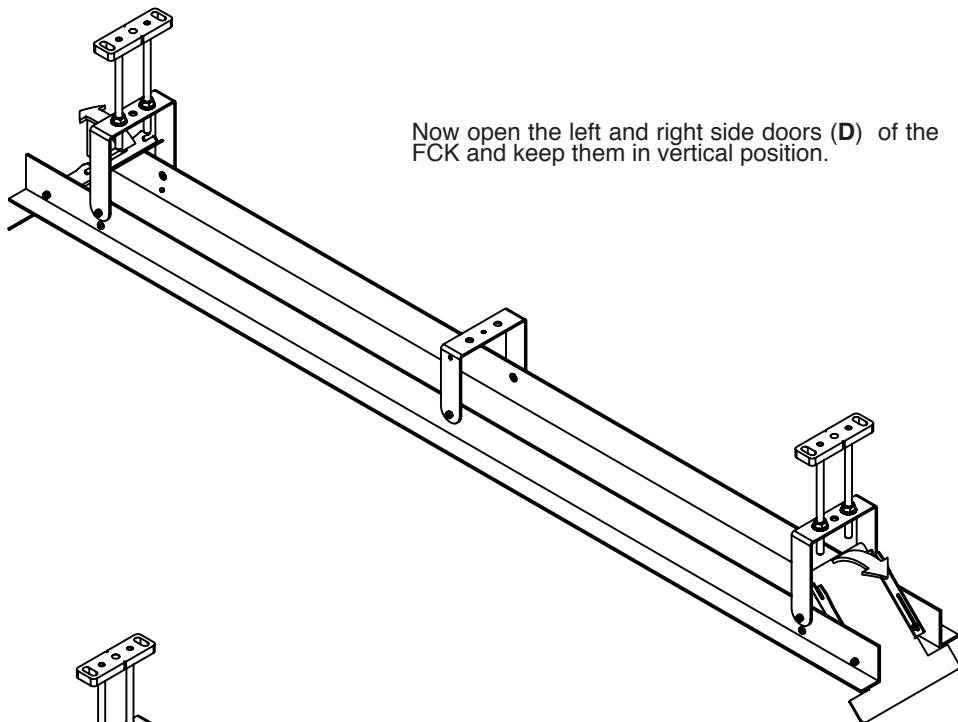

Lift up the screen housing inside the FCK, taking care that the holes of the screen mounting plates (E) and (F) are positioned under the threaded rods.

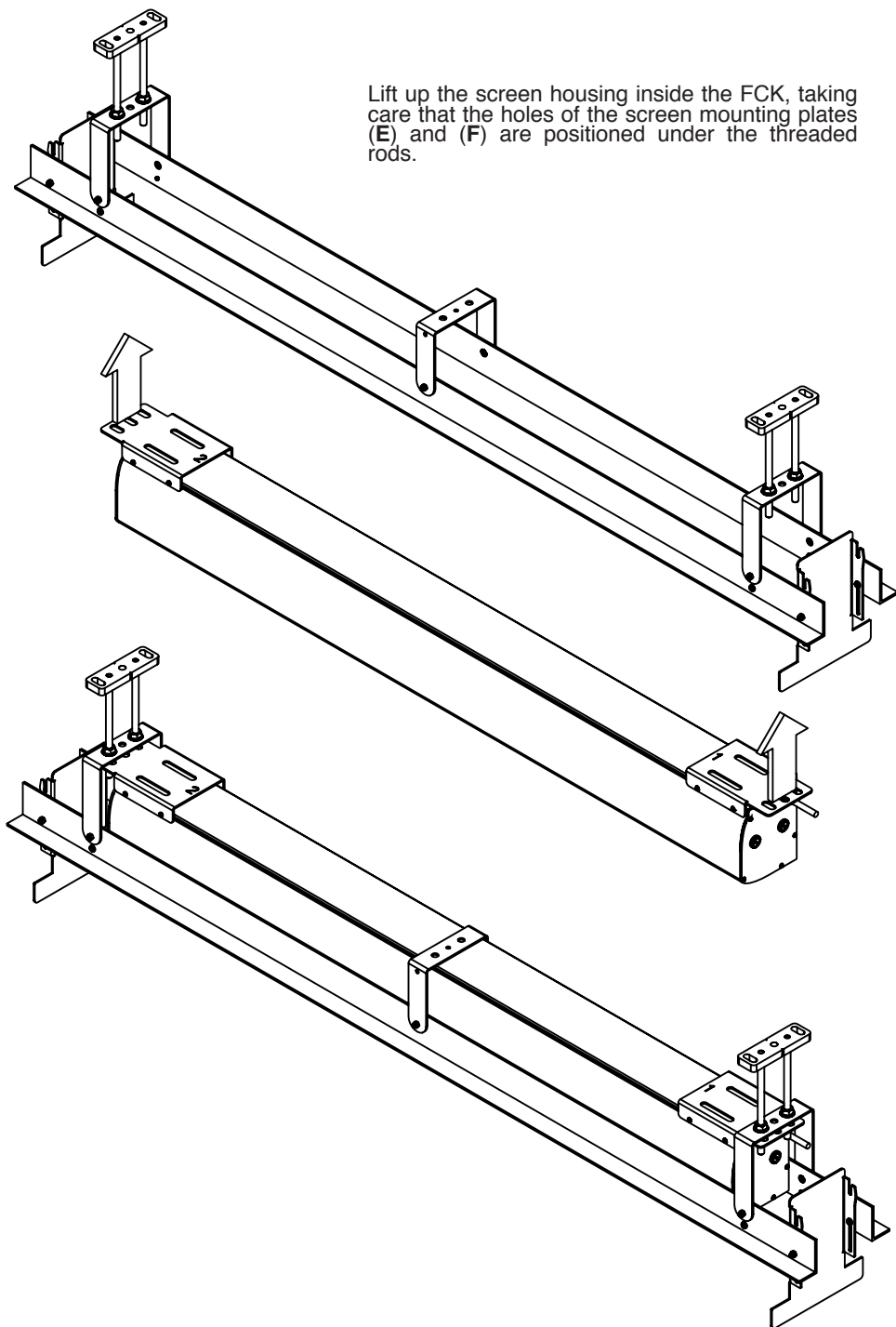

Fix the screen mounting plates to the threaded rods by using the nuts (**J**) for each threaded rod at each side.

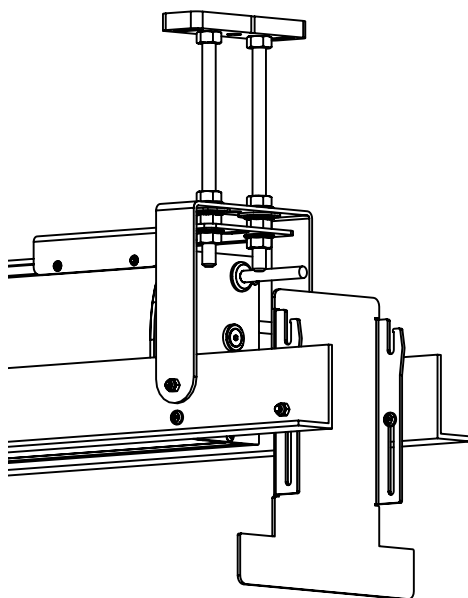
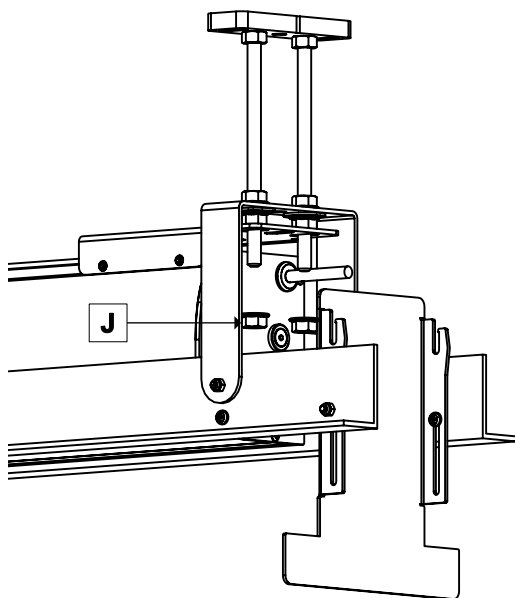

Before tightening the nuts, please check that the housing is perfectly centered with the FCK. Now, tighten firmly the flanged nuts (**J**).

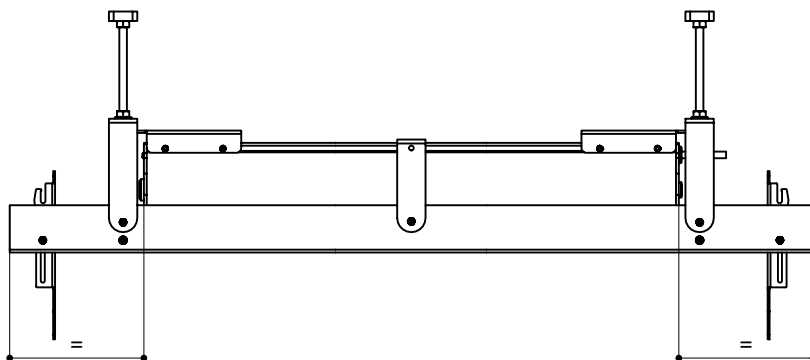

Now you can make the electrical connection of the screen motor and close the side doors.

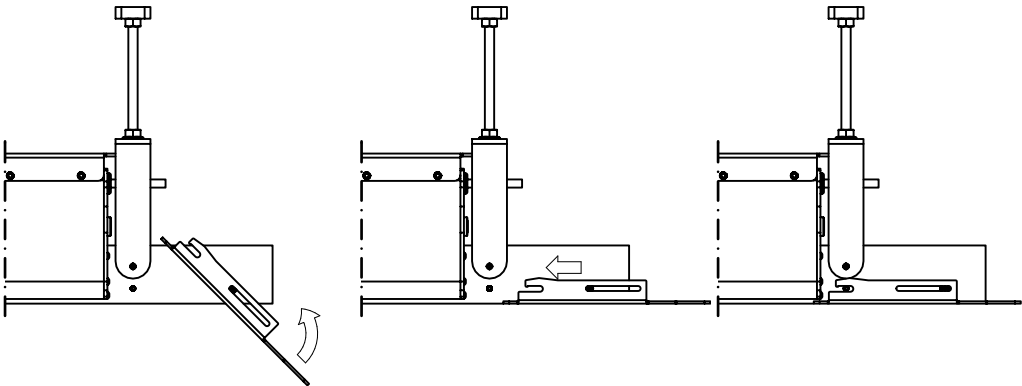
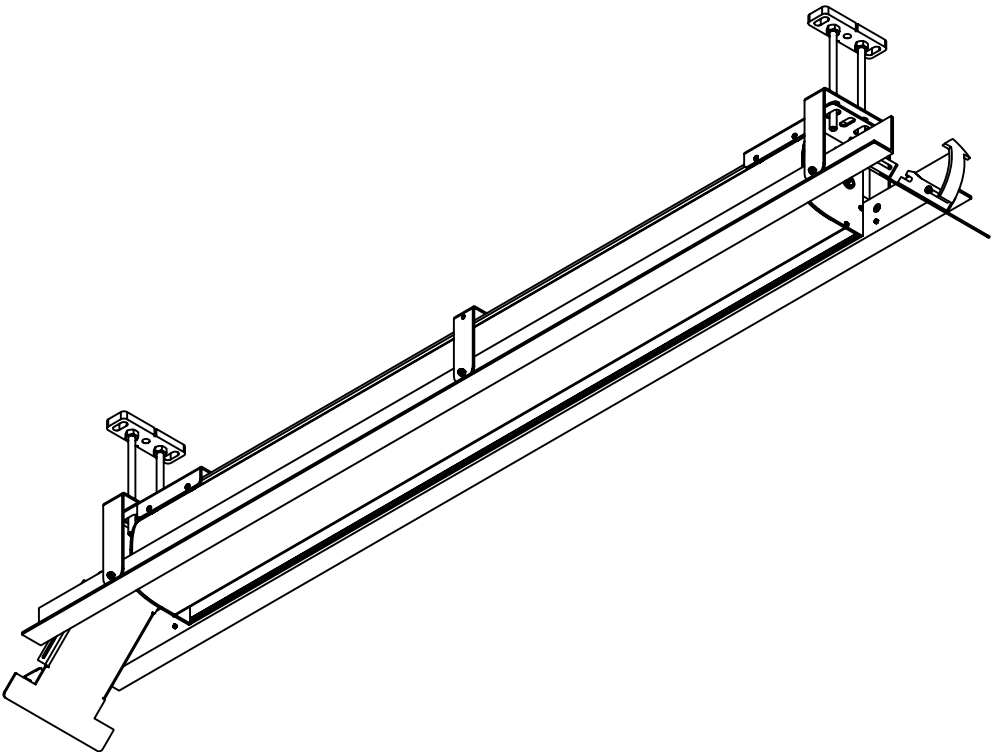

Produttore/Manufacturer/Hersteller/Produtor  
Euroscreen Srl – Via Stiria, 45/16 – 33100 Udine – Italy – VAT n. IT02162500306