

The **WALL EXTENSION BRACKETS** are available for both Compact and Major electrical screens. They are entirely made from aluminium and painted with white epoxy powders (RAL 9010). Mounted the screen on the wall using the extension brackets, the distance between the wall and the projection cloth will be as follows:

Wall extension bracket L = 395

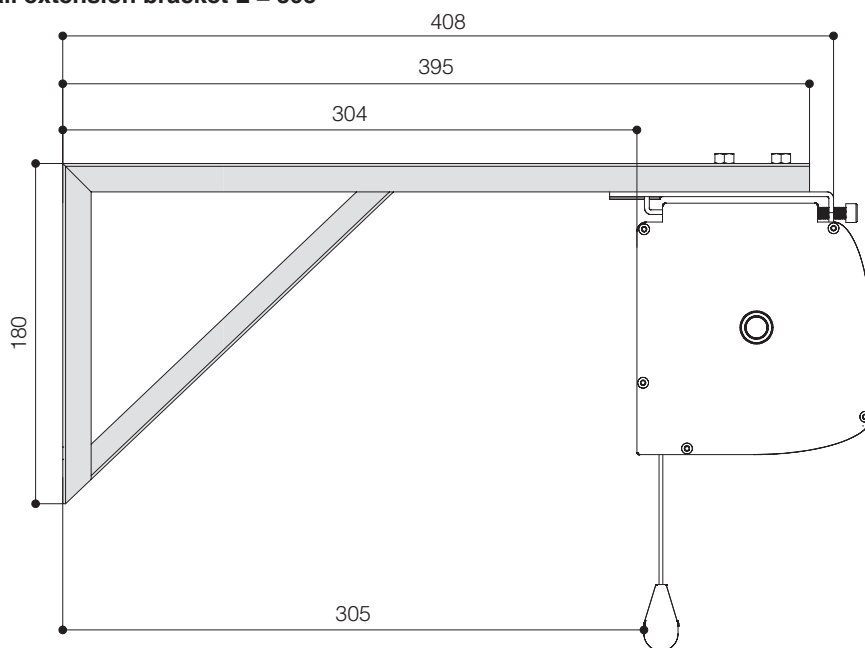

Short wall extension bracket L = 295

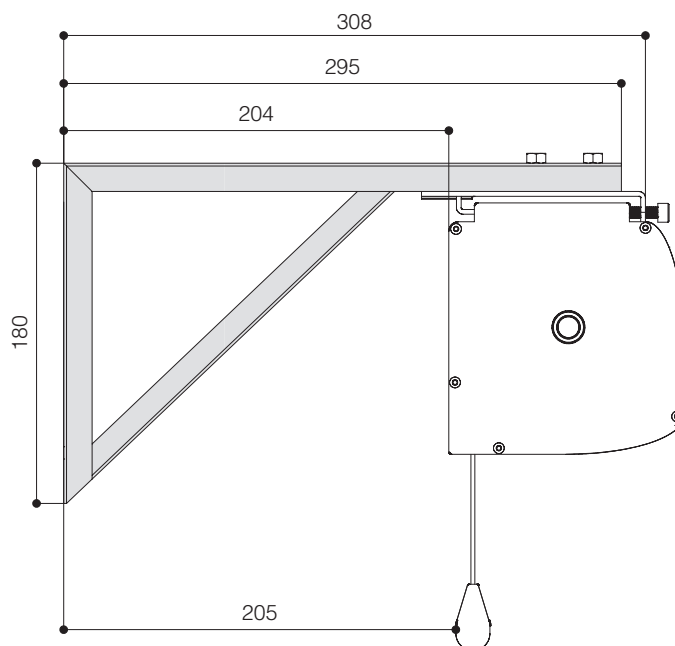

The measures in the drawings are expressed in millimetres.

Warranty: 24 months

ENGINEERED LIKE NO OTHER SCREEN IN THE WORLD